

Community Consultation on Potential Birsay Improvements



Orkney Islands Council wish to undertake some early consultation with the Birsay Community to get feedback on initial ideas to help improve the issues impacting the Village and the Brough of Birsay car park at the Point of Buckquoy.

Issues we are considering as part of the concept work: -

- Management of traffic and parking in the Brough of Birsay car park, including coaches, campervans and other visitors.
- Future-proofing and potential road safety issues.
- Coastal erosion and potential impacts on existing infrastructure.
- Safe and sustainable access to the Brough of Birsay and other local features.
- Outdated toilet facilities within the Village.

As part of investigations into ways to alleviate these and other issues, we have prepared some initial sketch options. These options include ideas for new toilet facilities and consider the capacity and location of parking in the Village, management of coach access alongside local traffic requirements, and long-term access issues to the Brough of Birsay car park. Potential delivery will be dependent on land ownership, funding, and statutory approvals.

We would appreciate it if you could take some time to look at the initial ideas and provide your comments via the online survey available at www.orkney.gov.uk/BirsayIdeas. Alternatively, comments can be emailed to ideas@orkney.gov.uk or posted to Birsay Ideas, Enterprise and Economic Growth, Orkney Islands Council, Council Offices, Kirkwall KW15 1NY. Paper copies of consultation materials are available by contacting ideas@orkney.gov.uk.

The consultation will close on 24 April 2023.

Plan 1

Birsay Village Car Park

This sketch focuses around the existing car park in the centre of the village.

Key things to note are:

- Extension of the existing car park area into the field to the east (approx. 12 more spaces)
- Potential further parking overflow in adjacent field to the north (approx. 20 more spaces)
- Introduction of screen planting between existing house and car park area
- Location of a new toilet block within the car park
- Opportunity to improve the pedestrian link between the car park and the Earl's Palace by creating a paved margin alongside the road
- Opportunity to give pedestrians priority between the car park and the Earl's Palace junction by using a coloured overlay on the road surface to denote a traffic calmed / pedestrian area

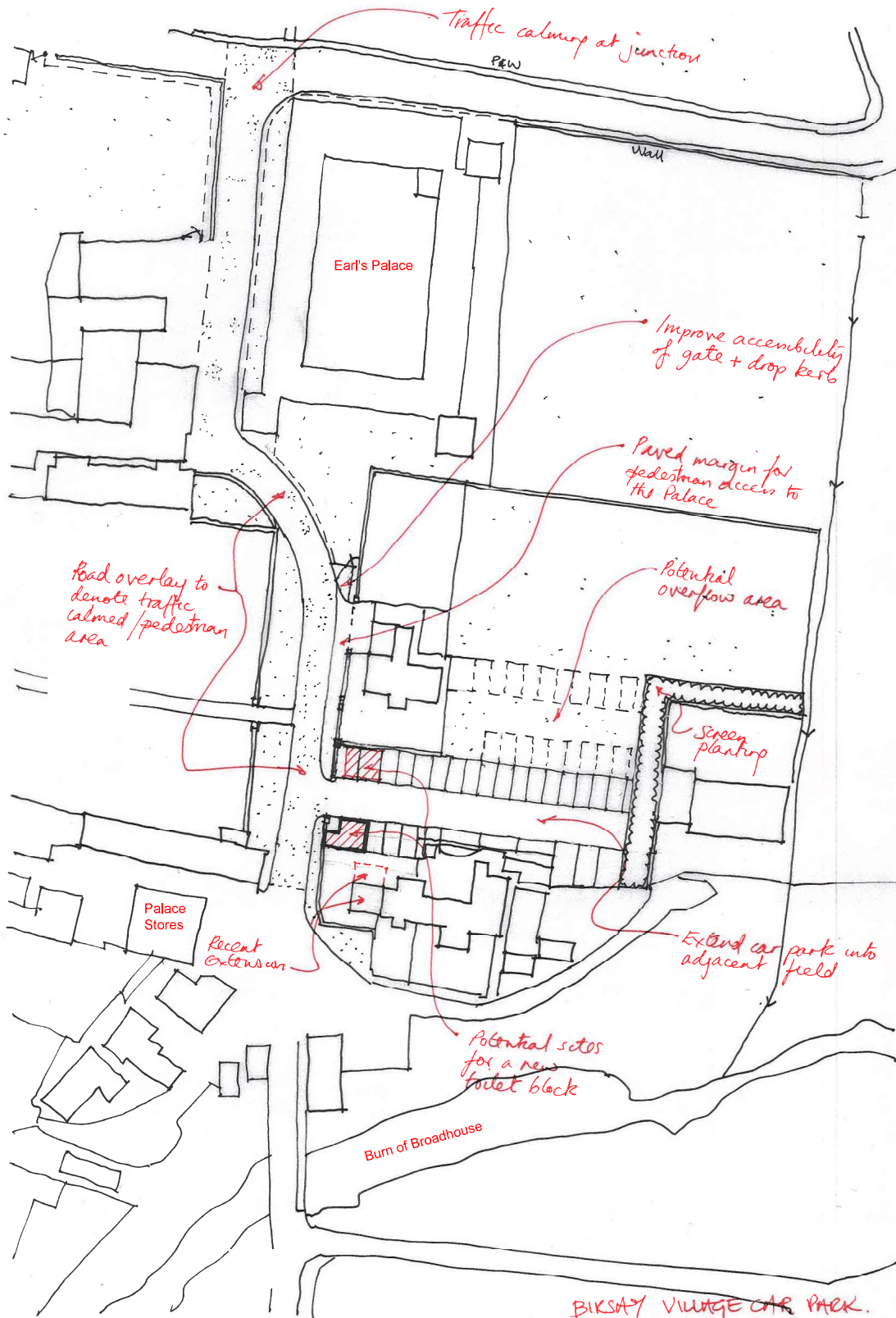

Plan 2

Field to South of St. Magnus House / East of Earl's Palace - New Car Park & Coach Turning Area

This sketch focuses on the field which lies to the south of St Magnus House, accessed from the main road to the east of the Earl's Palace.

Key things to note are:

- Introduction of a junction off the main road immediately to the west of the St Magnus House garden.
- Creation of a large car park area (approx. 42 car spaces, 4 campervan spaces and cycle parking)
- Coach drop-off area within the car park
- Use of reinforced grass parking bays to minimise the urbanity of the car park surface
- Create a direct / off road pedestrian link between the car park area and the Earl's Palace
- Accommodate coach turning within the car park to allow restrictions to coach access along the fragile coastal road
- Consider the introduction of a new toilet block either within the proposed car park, or within the existing car park within the village.
- Introduce screen planting between the new car park and the St Magnus House garden.
- Incorporate a gated access into the adjacent field for agricultural use.
- Retain existing parking within the village centre, accommodating spaces for disabled drivers.

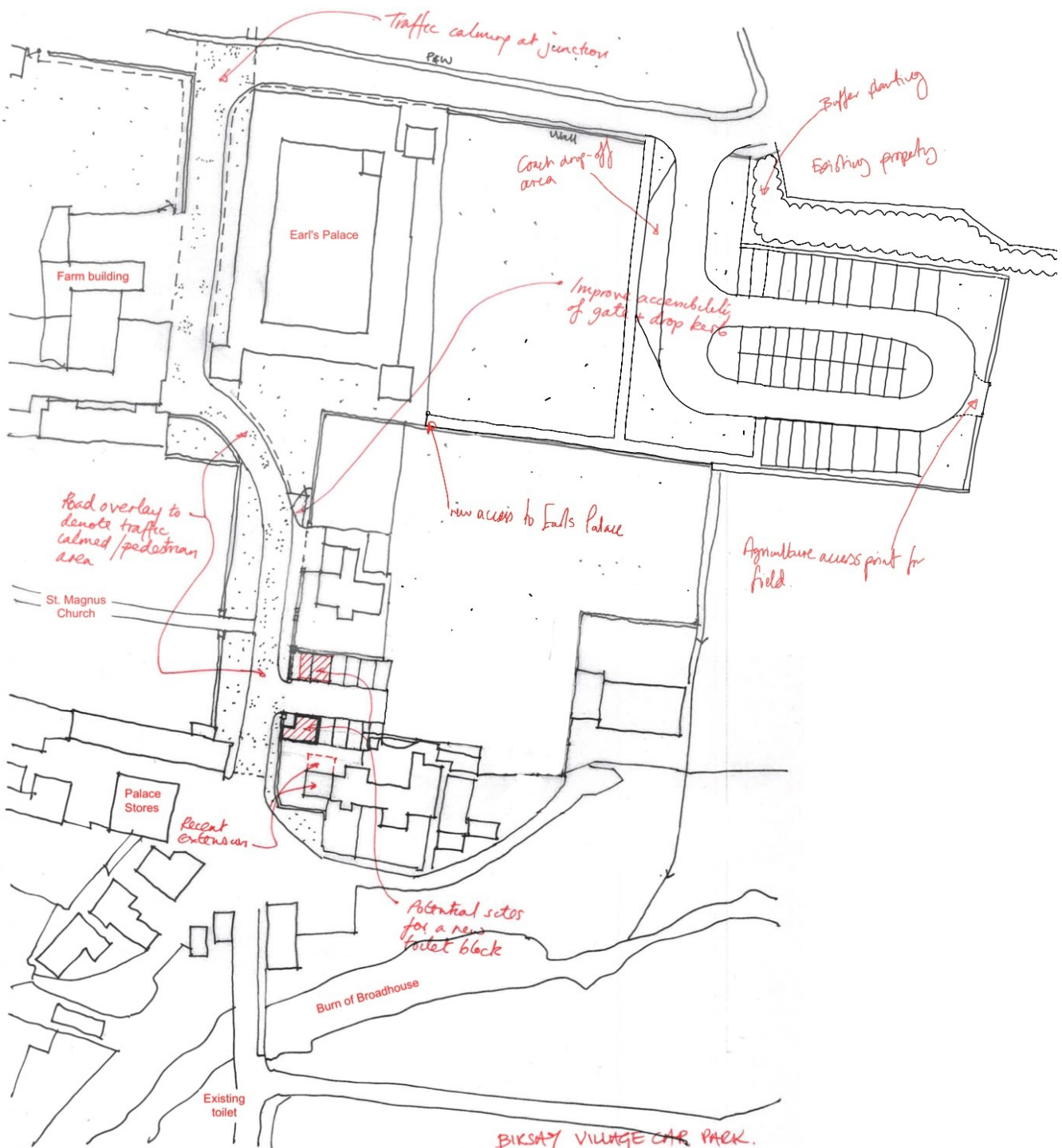

Plan 3

Field to East of Earl's Palace - Coach Turning Area

This sketch focuses on the introduction of a coach turning facility within the field which lies to the east of the Earl's Palace. It also proposes enlargement of the existing village centre car park as described for Plan 1

- Restriction to coach access beyond the new turning head to protect the fragile coastal road and relieve congestion.
- Extension of the existing village centre car park and proposals as Plan 1.

Key things to note are:

- Introduction of a coach turning area using part of the field to the east of Earl's Palace

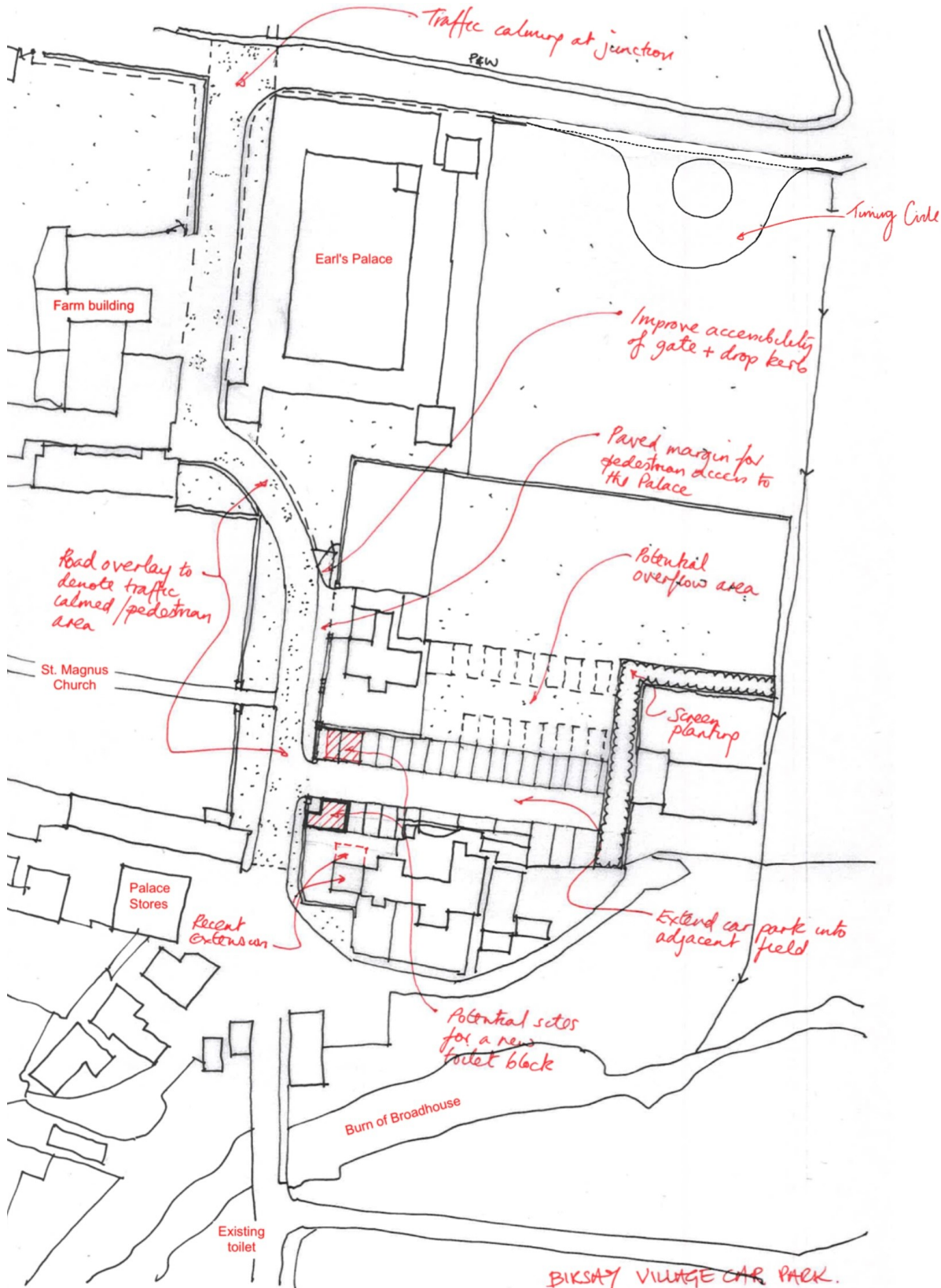

Plan 4

Field to North-West of Earl's Palace - Coach Turning Area

This sketch focuses on the introduction of a coach turning facility within the field which lies to the north-west of the Earl's Palace, at the south end of the coastal road. It is intended to restrict coach access along the fragile and narrow coastal road.

Key things to note are:

- Adaption of the existing bend to form a turning head
- The new turning head would utilise part of the field to the north-west of Earl's Palace (south of the field boundary wall)

- Restriction to coach access beyond the new turning head to protect the fragile coastal road and relieve congestion
- Increase the width of the main road to 6m and introduce a footway from the coach turning / drop off area to the Earl's Palace
- Introduce coastal road 'gateway' and road narrowing at the northern edge of the turning head demarcating the limit of coach access

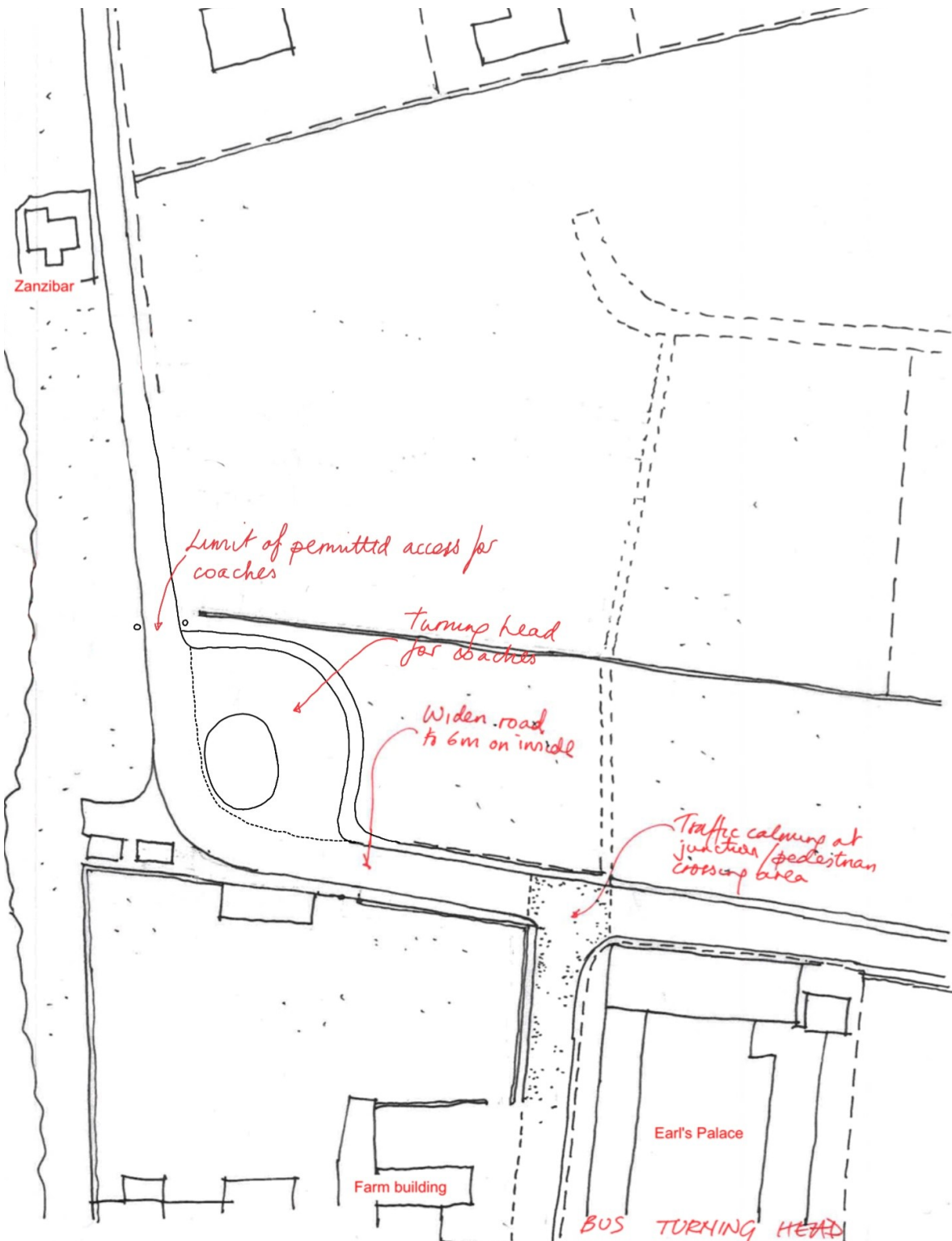

Community Consultation on Potential Birsay Improvements

Questions for online survey:

PLAN 1: Birsay Village Car Park

- Q1. Do you think this approach would be beneficial for Birsay?
(please select one)
Yes
No
Maybe
- Q2. Is there anything that you particularly like about this approach?
- Q3. Is there anything that you do not particularly like about this approach?
- Q4. Do you have any other comments / suggestions about this approach?

PLAN 2: Field to South of St. Magnus House / East of Earl's Palace – New Car Park & Coach Turning Area

- Q5. Do you think this approach would be beneficial for Birsay?
(please select one)
Yes
No
Maybe
- Q6. Is there anything that you particularly like about this approach?
- Q7. Is there anything that you do not particularly like about this approach?
- Q8. Do you have any other comments / suggestions about this approach?

PLAN 3: Field to East of Earl's Palace – Coach Turning Area

Q9. Do you think this approach would be beneficial for Birsay?
(please select one)

- Yes
- No
- Maybe

Q10. Is there anything that you particularly like about this approach?

Q11. Is there anything that you do not particularly like about this approach?

Q12. Do you have any other comments / suggestions about this approach?

PLAN 4: Field to North-West of Earl's Palace – Coach Turning Area

Q13. Do you think this approach would be beneficial for Birsay?
(please select one)

- Yes
- No
- Maybe

Q14. Is there anything that you particularly like about this approach?

Q15. Is there anything that you do not particularly like about this approach?

Q16. Do you have any other comments / suggestions about this approach?

GENERAL COMMENTS

Q17. Of the four plans, do you have a preferred option?
(please select one)

- None preferred
- Plan 1
- Plan 2
- Plan 3
- Plan 4

Q18. Are there any elements of the different options you would like to see combined to create a new option?

- No
- Yes (please provide details)

Q19. Do you have any other comments or information you wish to share in relation to any of the ideas presented?

Thank you for completing the survey. Your feedback will help us focus on what matters most to the community.